

quicktech
ENGINEERING AUS DEUTSCHLAND

**CNC MACHINE
TOOLS
MANUFACTURING** **T6**



blue
technology®



www.quicktech.com.tw



compact

CNC TURNING CENTERS *T6 compact*

Feature :

- Mitsubishi M70 Controller
- 6" chuck (Option : 8" chuck)
- 4,000 rpm high speed spindle
- 7.5 kw spindle power
- 12 station servo turret
(Option : power turret - BMT45)
- Hydraulic tailstock or sub spindle
for long work piece

Highlight :

- High precision linear guide ways are directly formed onto the machine bed and saddle during the casting process
- C3 class precision ball screws ensure the highest accuracy
- 45° slant design provides smooth chip disposal and easier operator access.
- The heavy-duty servo indexing turret achieves 0.2 second indexing times
- Available live tooling, and C-axis capabilities milling



Mitsubishi AC Servo **7.5kw**

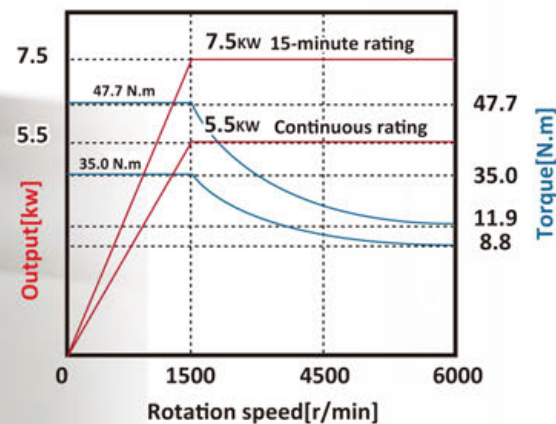

Tailstock

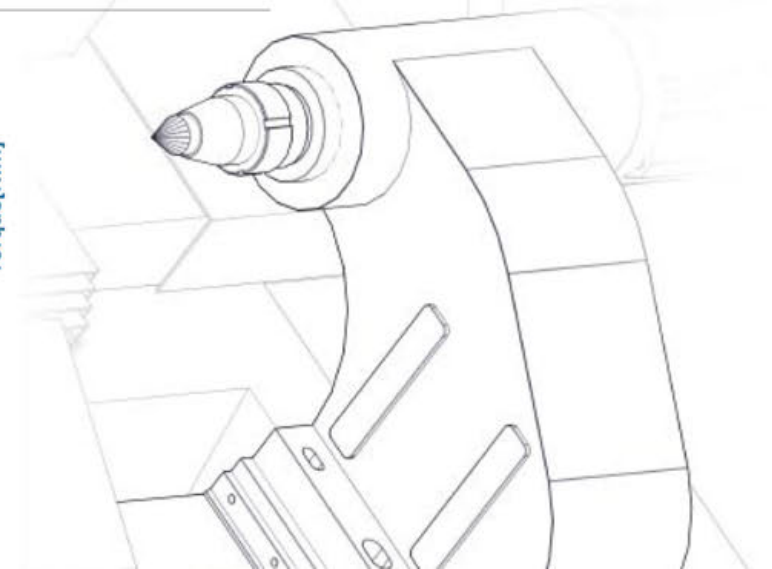

BMT-45 Turret

This compact machine will easily accomplish the demanding turning applications for mass production. Furthermore, with available live tooling, and C-axis capabilities milling, turning applications can be completed in one single machine.

Linear Guideways

The machine is equipped with high precision, HIWIN linear guideways.

The use of 35mm rails throughout the machine increases stability and accuracy, and allows heavier cuts to be achieved.

All axes are equipped with digital drives that deliver feed velocities of 30m/ min.

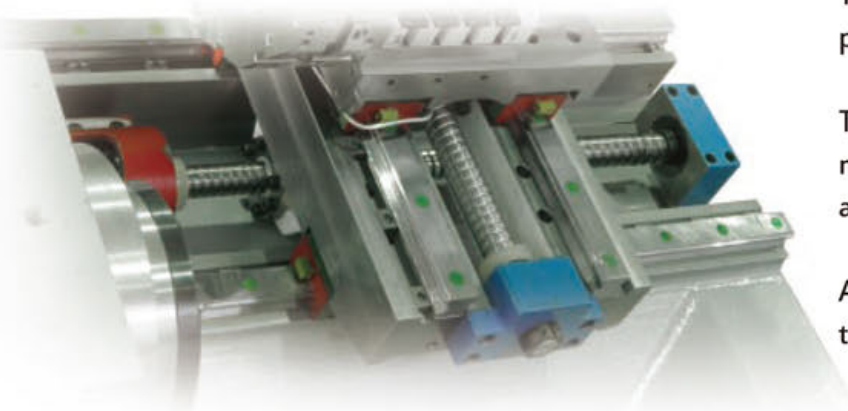
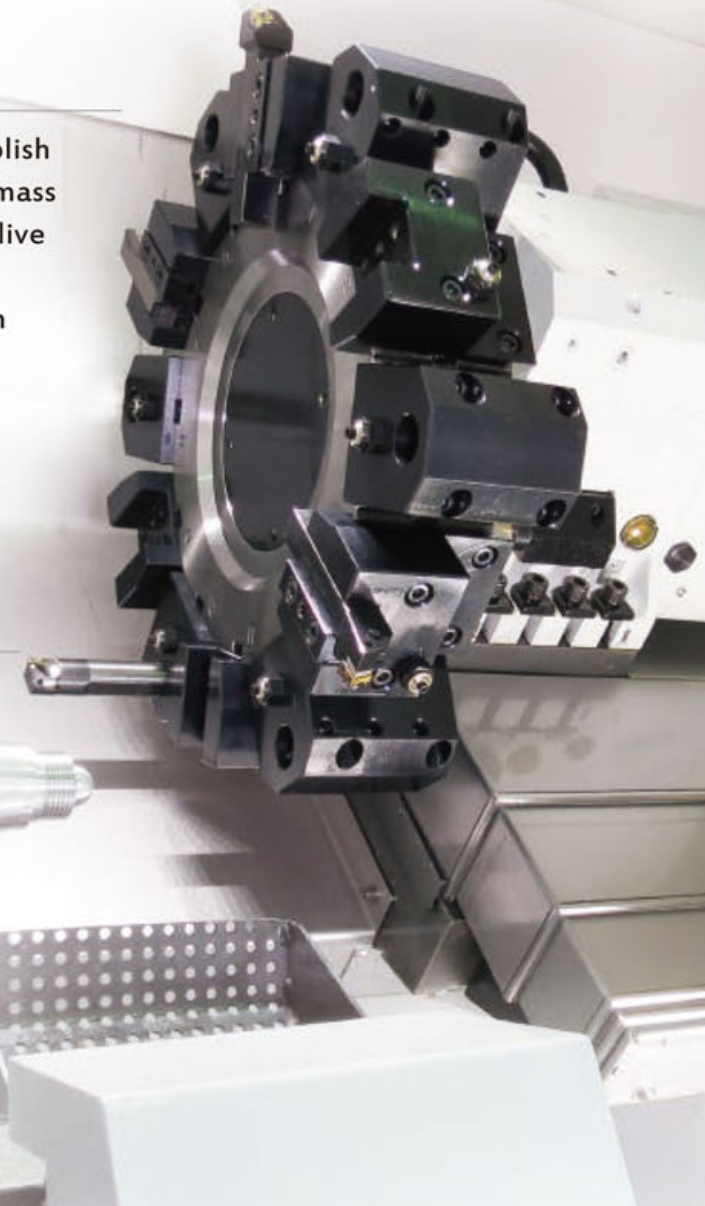
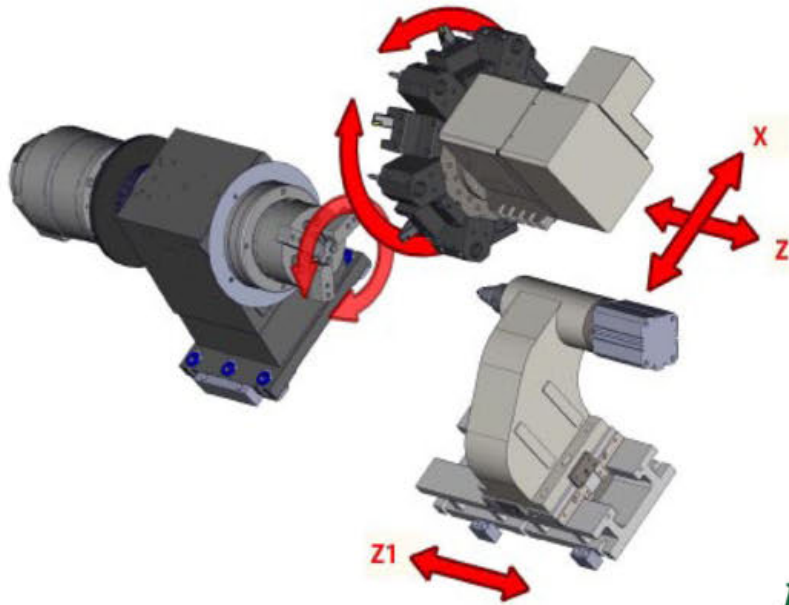

Turret Tooling system

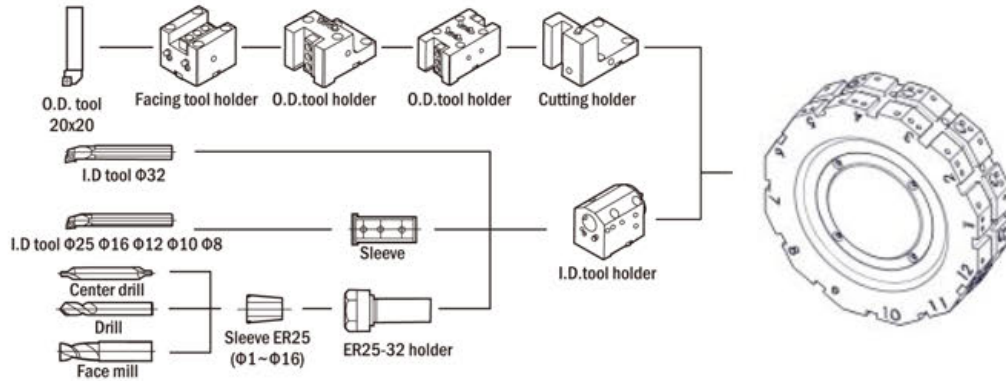

Turret interference

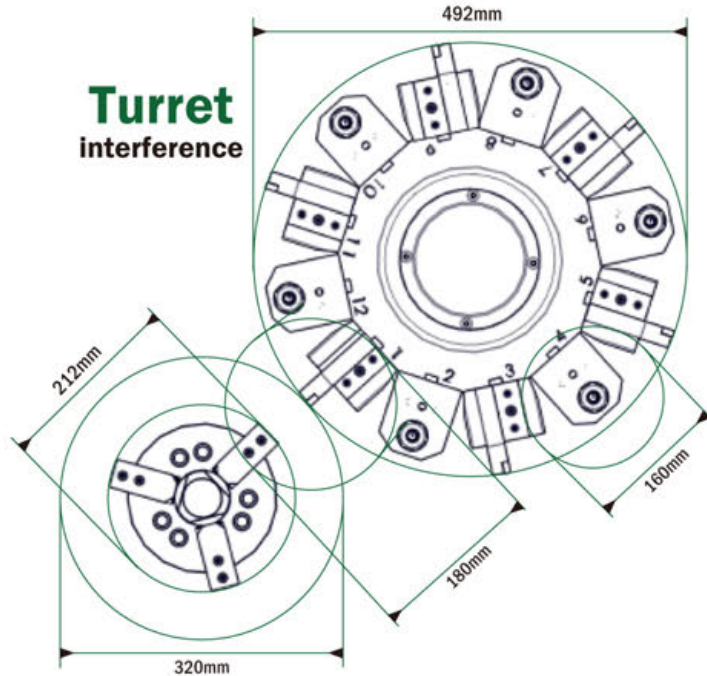

External view

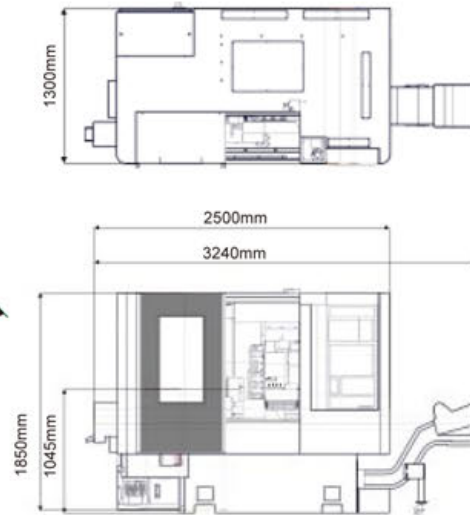

T6 Specification CNC Turning Center

Machine Type		T6-compact	T6-Twin
Mitsubishi Controller		M70	
Spindle Capacity	Spindle bar capacity	42.0mm(60.0mm)	
	Swing over Bed	400.0mm	
	Hydraulic pressure(max)	35 kgf/cm ²	
	Collet chuck size	6" chuck or 173E-42B Collet chuck	
	Spindle nose	ISO (DIN) A2-5/ISO (DIN) A2-6	
Sub-Spindle Capacity	Spindle bore	44.0 mm(65.0mm)	
	Collet chuck size	N/A	5" chuck
Travel	X axis Travel	200 mm	
	Z axis Travel	300mm	
	Z1 axis Travel	N/A	300mm
Axes	X axis ball screw	$\Phi 32 \times P10$	
	X axis linear guide way	35.0mm	
	Z axis ball screw	$\Phi 32 \times P10$	
	Z axis linear guide way	35.0mm	
	X & Z rapid feed	30m/min	
A.T.C system	Turret/ Tools number	Servo Turret 12 tools	Power Turret 12 tools
	Tool shank Size	20mm	
	Drilling holder Size	ER-25/25mm	
Motor	Main Spindle	Mitsubishi AC Servo 7.5kw	
	X axis Servo Motor	Mitsubishi AC Servo 1.5kw	
	Z axis Servo Motor	Mitsubishi AC Servo 1.5kw	
	Z1 axis Servo Motor	N/A	Mitsubishi AC Servo 1.0kw
	Coolant pump motor	4T2-2	
	Hydraulic pump motor	1hp	
	Chip Conveyor Motor	1/4 hp	
Accuracy	Position / Repeatability	0.001mm	
Tailstock	Tailstock quill dia.	32.0mm	-----
	Quill taper/ travel	70.0mm	-----
Coolant System	Max. coolant pressure	7.5 / 10 bar	3.5 kgs
	Max. coolant flow	67 L/min	
Lubrication System	Tank Capacity	2 Liters	
	Pump pressure/ flow rate	15kgf/cm ² / 100cc/min	
Machine Size	Length	2500 mm	
	Width / Height	1300 / 1850 mm	
	Weight	3000 kg	3500 kg



QUICK-TECH

Quick-TECH Machinery Co., Ltd.

709 No.35 Keji 1st Road Tainan City, Taiwan, R.O.C
 Tel-No : +886-6-3841166 Fax-No : +886-6-3841177
<http://www.quicktech.com.tw> e-mail : inquiry@quicktech.com.tw

